

My Vac+™ Commercial Lightweight Cleaner with Dirt Cup

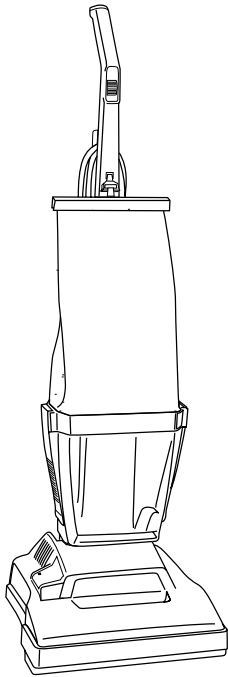

**Review this manual
before operating the
cleaner**

Index

Assembling Cleaner	2-4
How To Use	
Cleaner Description	4
If You Have a Problem	7
Important Safeguards	1
Maintenance	
Authorized Service	7
Emptying Dirt Cup	5
Lubrication	7
Replacing Belt	5
Replacing Brush Roll	6-7

OPERATING INSTRUCTIONS

ENGLISH → pp.1-8

ESPAÑOL → pág 9-13

FRANÇAIS → p. 14-18

Record and retain

Model _____ Serial No. _____

(Located on bottom of cleaner)

Important Safeguards

When using an electrical appliance, always follow basic precautions, including the following:

READ ALL INSTRUCTIONS BEFORE USING THIS APPLIANCE

Warning:

To reduce the risk of fire, electric shock, or injury:

- Do not use outdoors or on wet surfaces.
- This appliance is provided with double insulation. Use only identical replacement parts. See instructions for servicing double insulated appliances.
- Close supervision is necessary when any appliance is used by or near children. Do not allow vacuum cleaner to be used as a toy or to run unattended at any time.
- Keep hair, loose clothing, fingers, feet and all parts of body away from openings, rotating agitator and other moving parts. Do not operate cleaner in bare feet or when wearing open toe shoes or sandals.
- Do not pick up anything that is burning or smoking, such as cigarettes, matches, or hot ashes.
- Do not use to pick up flammable or combustible liquids such as gasoline or fine wood sandings or use in areas where they may be present.
- Avoid picking up hard, sharp objects with the cleaner. They may damage the cleaner.
- Do not use without dust bag or dirt cup in place. Shake outer bag and empty dirt cup frequently when picking up very fine materials such as powder.
- Use extra care when cleaning on stairs.
- Do not put any object into openings. Do not use with any opening blocked; keep free of dust, lint, hair, and anything that may reduce air flow.
- Do not pull or carry by cord, use cord as a handle, close door on cord or pull cord around sharp edges or corners. Do not run appliance over cord. Keep cord away from heated surfaces.
- Always disconnect cord from electrical outlet before servicing the cleaner.
- Unplug cleaner when not in use. Turn off all controls before unplugging.
- Do not unplug by pulling on cord. To unplug, grasp the plug, not the cord. Never handle plug or appliance with wet hands.
- The use of an extension cord is not recommended. If an extension cord is absolutely necessary, use at least a 16 gauge cord and as short as possible.
- Do not use with damaged cord or plug. If appliance is not working as it should, has been dropped, damaged, left outdoors, or dropped into water, take it to a Pacific Floor Care Warranty Service Dealer.
- Use vacuum cleaner only for its intended use as described in this owner's manual. Use only attachments recommended by Pacific Floor Care; others may cause hazards.

Save these instructions!

DOUBLE INSULATED: When servicing, use only identical replacement parts. This cleaner meets Occupational Safety and Health Act (OSHA-29 CFR 1910 Subpart S) requirements.



1. Assembling cleaner

It is extremely important to read and follow all the assembly steps in order.

Carton contents

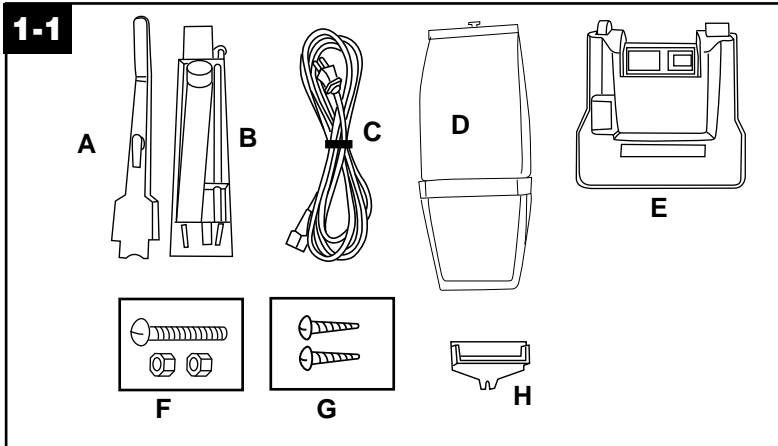

Remove all parts from carton and identify each item shown. Make sure all parts, especially small items, such as G and F, are located before disposing of cardboard packaging.

A. Upper handle
B. Lower handle
C. Cord
D. Dirt cup assembly
E. Cleaner body

F. Handle bolt and nut packet (One extra nut included)
G. Dirt cup screws (2)
H. Dirt cup support

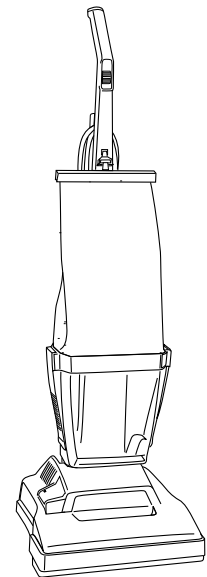

Step 1 Assemble handle

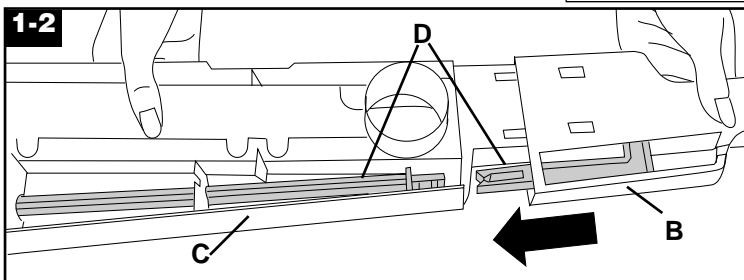
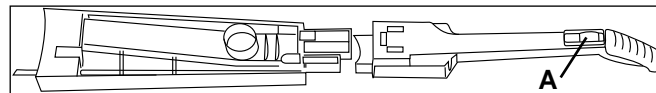

Note: The **white switch lock** above the ON/OFF (A) switch helps in the assembly of your cleaner. Assembly can be continued if the switch lock is missing. However, **do not remove** the switch lock until assembly is completed.

Align upper handle and lower handle as shown.

Place upper (B) and lower (C) handle parts on a flat surface, aligning rod sections (D). With hands on sides of handle, push parts together firmly until they “click” and rod sections lock together.

***Do not press against the grey rod extending from the lower handle shown in Fig. 1-3 (E). Do not push handle together with hands on ends of sections.**

Step 2 Attach cord

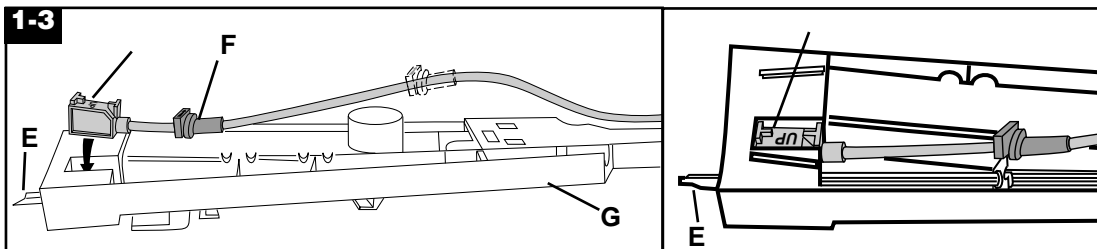

Insert **large** rectangular end of cord into pocket in bottom of handle, with side marked “UP” visible.

Make sure rectangular end is pushed into the handle as far as possible.

Slide cord protector (F) toward upper handle (G).

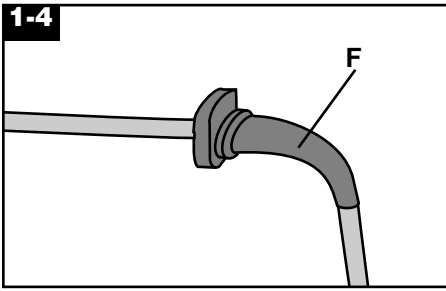

Rotate cord protector (F) as shown.

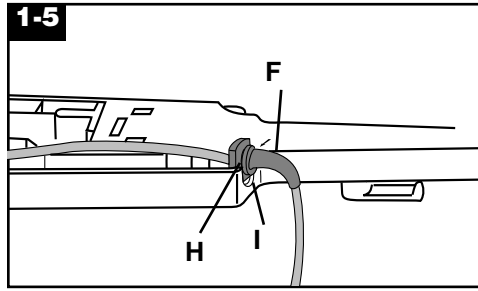

With (F) pointing downward (toward back of handle), press groove (H) into slot (I).

Pull cord tight.

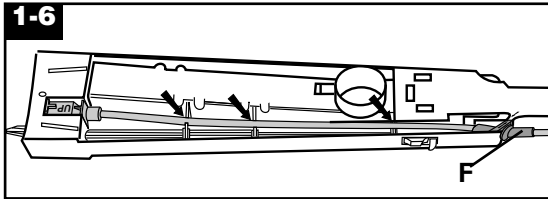
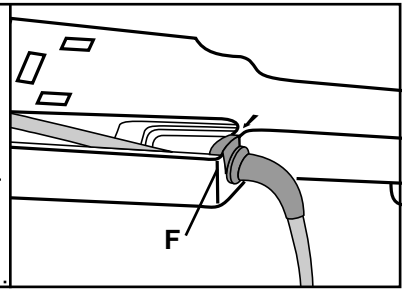

Press cord into place at each of the three notches indicated and note correct positioning of (F).

Do not plug cleaner in until assembly is totally complete.



Note proper placement of cord at notch as shown.

Step 3 Attach dirt cup assembly

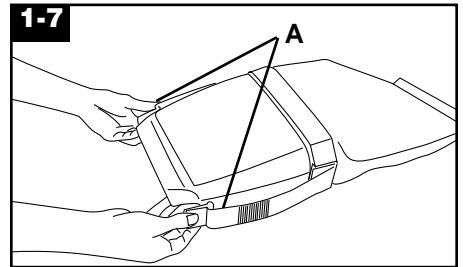

Release dirt cup latches (A) by pulling them outward. Remove cup and set it aside.

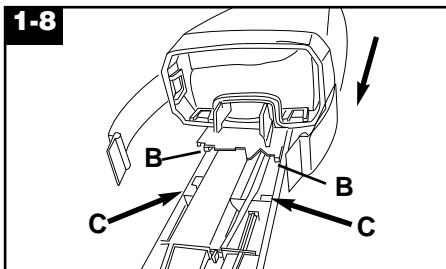

Slide extensions (B) on lower back of cloth bag into slots (C) in lower handle.

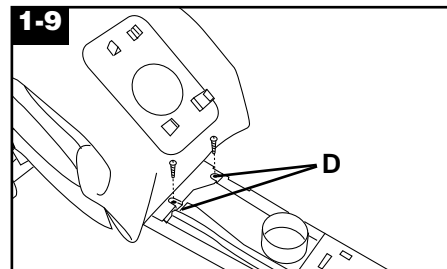

Insert the two screws at area shown (D). Tighten screws.

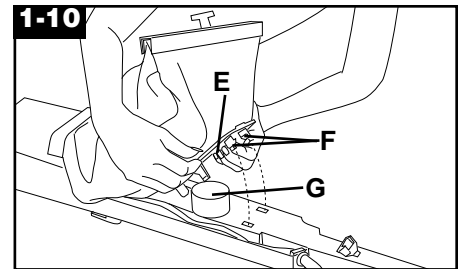

Note round opening (E) and hooks (F) on back of cloth bag. Place opening over dirt tube (G).

Press down firmly to snap hooks into handle.

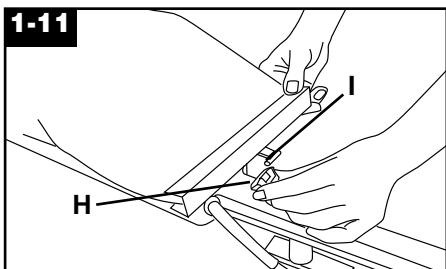

On upper handle, grasp bag clip retainer (H) and pull down firmly. Hook bag clip (I) into slot in retainer.

Step 4 Attach handle

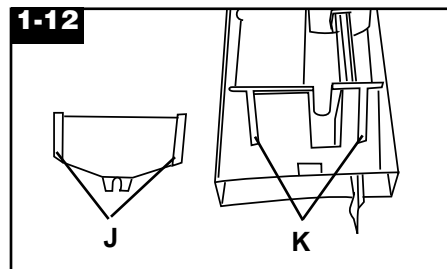

Note location of tapered rails (J) on dirt cup support (K) and on lower handle.

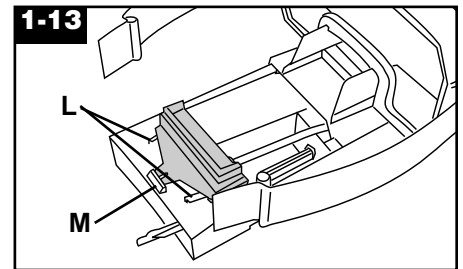

Slide rails on support onto rails (L) on lower handle until support snaps past the lock tab (M).

Continued →

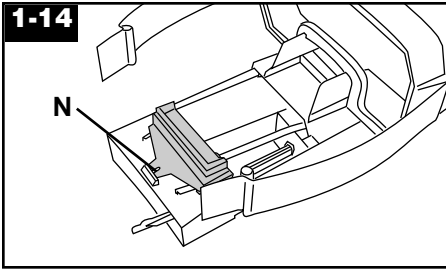

Pull support toward bottom of handle slightly to make sure support is locked in place.

Make sure hole in handle (N) is visible through hole in support.

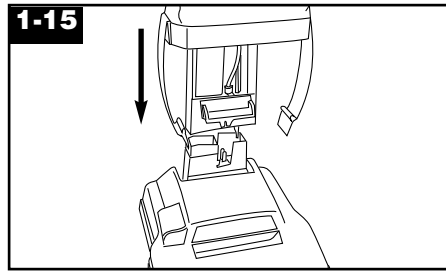

With cloth bag to the front, place assembled handle onto handle base of cleaner body.

Rock handle side to side while pushing down firmly. Extra pushing effort may be required.

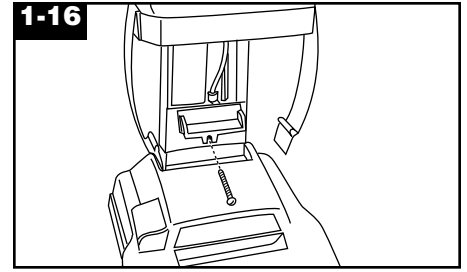

Push **bolt** into hole on lower **front of handle**.

If bolt will not go through hole easily, handle is not pushed completely down.

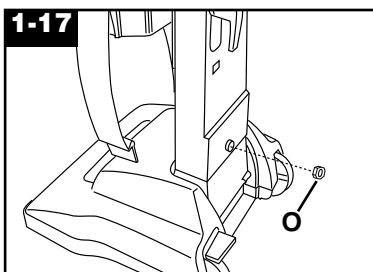

Place **nut (O)** in recessed area at **back of handle**. Hold nut in place while tightening bolt securely with a screw driver.

Note: Only one nut is needed on this model. The extra nut is not required but has been provided for your convenience.

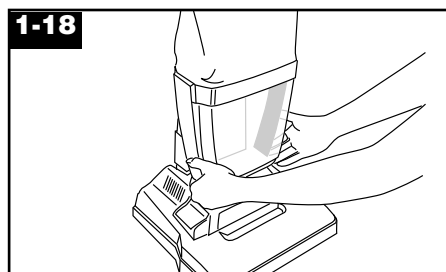

Reposition dirt cup into support at bottom of cloth bag and snap latches into position.

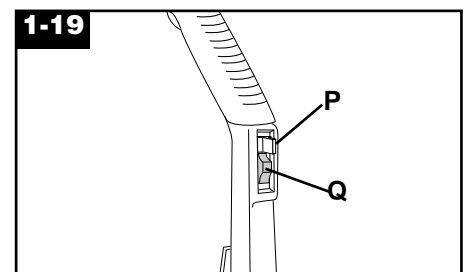

Pull switch lock (P) above ON-OFF switch (Q) straight out.

Dispose of lock.

Note: If lock has come off during assembly, make sure switch is in the OFF position (down) before plugging cord in to electrical outlet.

2. How to use

Cleaner description

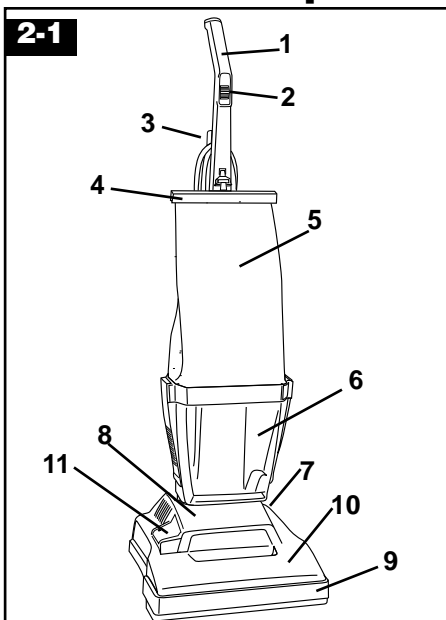

The assembled cleaner will look like the drawing.

1. **Handle**
2. **ON/OFF switch**
3. **Cord hooks:** wrap cord around hooks for storage.
4. **Bag cap**
5. **Cloth bag**
6. **Dirt cup**
7. **Handle release lever:** step on lever to lower handle to operating or low position.
8. **Cleaner body**
9. **Furniture guard:** helps prevent cleaner from marking furniture.
10. **Hood**
11. **Extra belt storage:** open door to store extra belt.

Operate cleaner only at voltage specified on data plate on bottom of cleaner.

WARNING: electrical shock could occur if used outdoors or on wet surfaces.

To reduce the risk of electric shock, this appliance has a polarized plug (one blade is wider than the other). This plug will fit in a polarized outlet only one way. If the plug does not fit fully in the outlet, reverse the plug. If it still does not fit, contact a qualified electrician to install the proper outlet. Do not change the plug in any way.

ON-OFF switch

To turn cleaner ON, push switch up.

To turn cleaner OFF, push switch down.

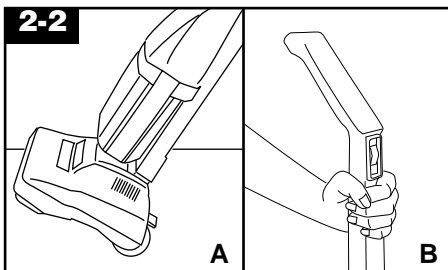

Transporting cleaner

To move your cleaner from room to room, put handle in upright position, tilt cleaner back on rear wheels and push forward (A).

The cleaner can also be moved by lifting it as shown in (B).

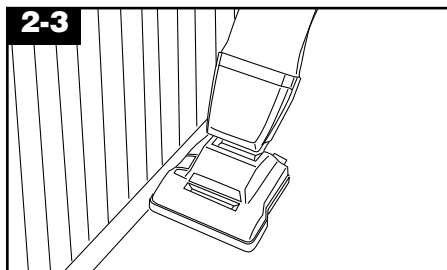

Edge cleaning

Edge cleaning is provided on both sides of nozzle to remove dirt in carpet near baseboards and furniture. Guide either side of nozzle parallel to edge of carpet or furniture.

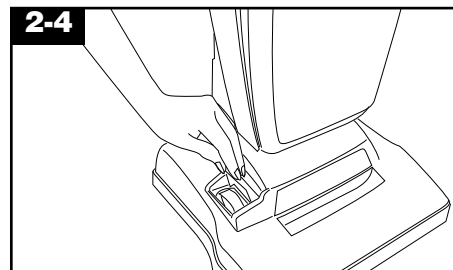

Belt storage

Lift door to conveniently store extra belt.

3. Maintenance

Emptying dirt cup

Frequently check the dirt level in the dirt cup. **It is recommended that you empty cup when dirt level reaches "Full Line" on front of cup.** If more dirt is allowed to accumulate, your cleaner may not operate effectively and spillage may occur when cup is removed.

How to empty

Turn cleaner OFF and disconnect from electrical outlet.

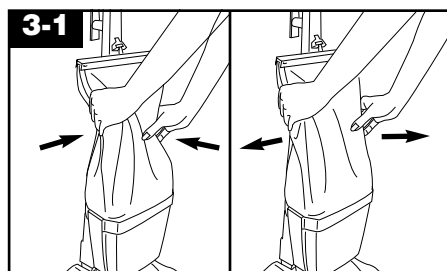

With handle in upright position, grasp sides of cloth bag. Push sides of bag in and pull out vigorously to release dirt accumulated in bag. Allow a few seconds for dirt to settle into cup.

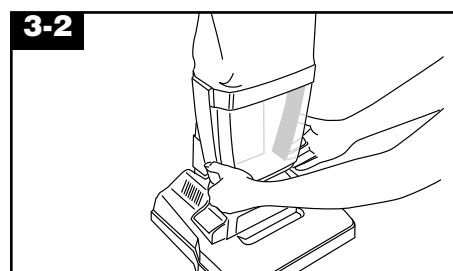

While supporting bottom of cup, release the two latches by pulling them outward. Remove cup and empty it. Reposition cup into support at bottom of bag and snap latches into position.

The belt

What to buy

Use only genuine Pacific Floor belt, **part No. 38528027** with your cleaner.

When to replace

Disconnect cleaner from electrical outlet.

To check belt, remove bottom plate and hood as shown in "How to replace belt". Replace belt if it is stretched, cut or broken.

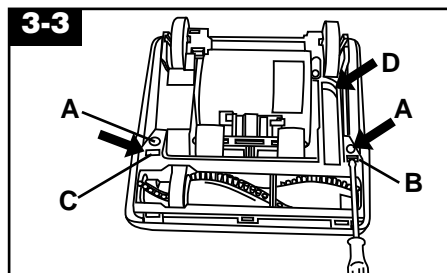

How to replace

Disconnect cleaner from electrical outlet.

Place handle in lowest position. Turn cleaner over and remove the two bottom plate screws (A).

To remove bottom plate, insert end of flat screwdriver into wide area of right-hand slot (B) and push handle of screwdriver to the rear. Repeat in left-hand slot (C).

Lift extension (D) of bottom plate, rotate plate and remove from cleaner body.

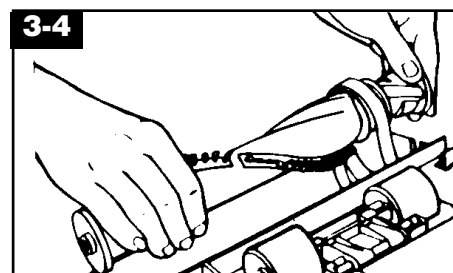

Remove agitator and broken agitator belt.

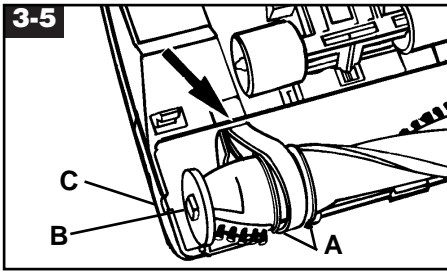

Slip agitator through new belt (**with lettering toward outside of cleaner**) and position belt in belt guide (A).

Push end of belt into opening in cleaner body.

Reposition agitator making sure to align flat sides of projection (B) on belt end of agitator with flat sides of slot (C) in cleaner body.

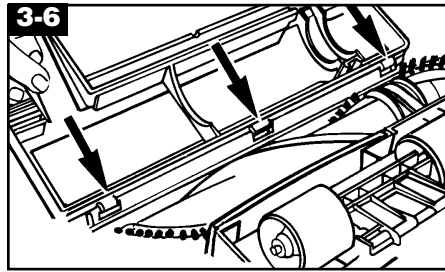

Place the three tabs on bottom plate into slots in front of cleaner body. Snap bottom plate into place over agitator.

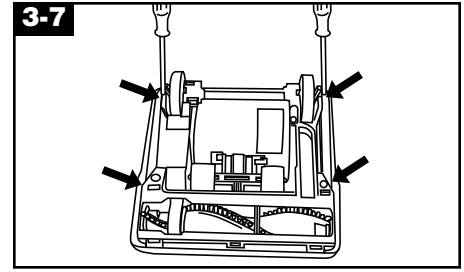

Remove hood

Place handle in operating position and turn cleaner over. Insert end of flat screwdriver into one of the four slots beside an arrow on bottom of cleaner.

For slots nearest wheels, push handle of screwdriver toward cleaner handle; for remaining two slots, pry outward to release latches.

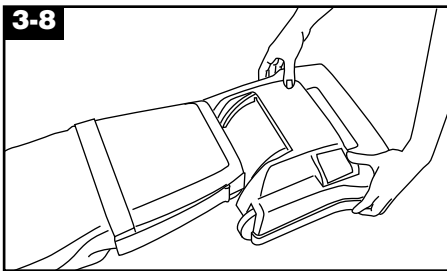

Turn cleaner over and lift off hood.

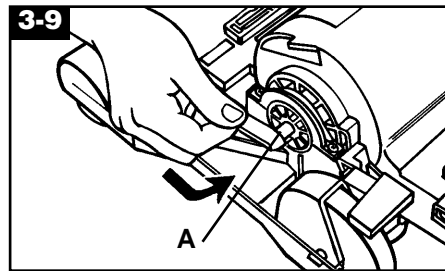

Stretch new belt onto motor pulley (A).

Extra effort may be required to stretch belt onto pulley.

Turn agitator, making sure belt is not pinched between agitator and cleaner body. The belt must rotate freely inside the belt guide. If the agitator does not turn, remove bottom plate and reposition belt in the belt guide.

Replace hood.

The agitator

Disconnect cleaner from electrical outlet before checking or replacing brushes.

What to buy

When purchasing a new brush roll (assembly complete), ask for **part No. 48414081**.

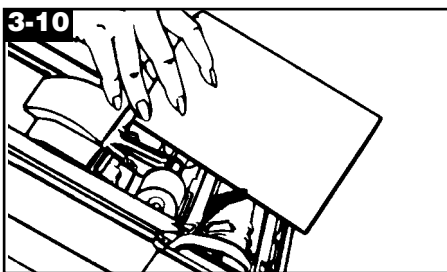

When to replace

To check condition of brushes, move edge of a card across bottom plate while turning agitator. Replace agitator if brushes do not touch card.

Note: The agitator belt should be replaced each time the brush roll is replaced.

How to replace brush roll - assembly complete

Disconnect cleaner from electrical outlet.

1. Remove hood as shown in Figs. 3-7 through 3-8 of **"How to replace belt"**.
2. Pull belt off motor pulley (A), shown in Fig. 3-9.
3. Remove bottom plate and agitator as shown in Figs. 3-3 and 3-4.
4. Remove agitator from cleaner and discard.
5. Reposition belt and new agitator beginning with Fig. 3-5.

3-11

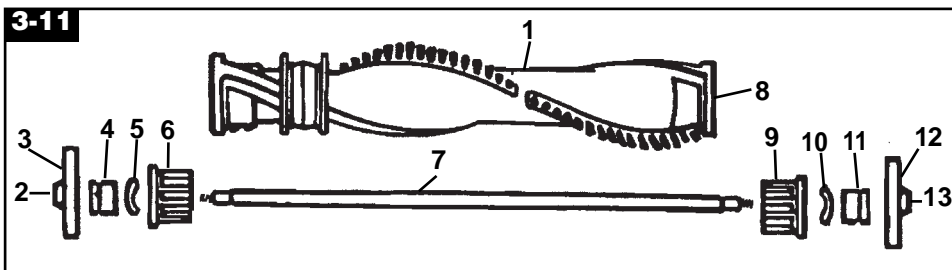

Use this illustration for agitator reassembly, if necessary. Washer must be placed between agitator ends and bearing.

- 1. Brush roll core
- 2. Flat sided projection
- 3. End plate
- 4. Bearing
- 5. Washer

- 6. Agitator end
- 7. Shaft
- 8. End section
- 9. Agitator end
- 10. Washer
- 11. Bearing
- 12. End plate
- 13. Round projection

Lubrication

The motor is equipped with bearings which contain sufficient lubrication for the life of the motor. The addition of lubricant could cause damage. **Do not add lubricant to motor bearings.** The agitator is equipped with two ball bearings that should be lubricated periodically by a Pacific Floor Service Center.

Service

To obtain approved service and genuine parts, locate the nearest **Pacific Floor Service Center** by checking the Yellow Pages under "Vacuum Cleaners - Household".

If further assistance is needed, contact Pacific Floor, 2259 Sheridan, Muskegon, Michigan 49442
Phone (800) 968-1332
www.nextwaveofclean.com

Always identify your cleaner by the **complete** model number when requesting information or ordering parts. (The model number appears on the bottom of the cleaner.)

Servicing of double-insulated appliances

This vacuum cleaner is double insulated. In a double-insulated appliance, two systems of insulation are provided instead of grounding. No grounding means is provided on a double-insulated appliance, nor should a means for grounding be added. Servicing a double-insulated appliance requires extreme care and knowledge of the system, and should be done only by qualified service personnel. **Replacement parts must be identical to those parts being replaced.** A double-insulated appliance is marked with the words "DOUBLE INSULATION" or "DOUBLE-INSULATED". The symbol  may also be marked on the appliance.

If you have a problem

If a minor problem occurs, it usually can be solved quite easily when the cause is found by using the check list below.

Problem: Cleaner won't run

Possible cause
Possible solution

- **Not firmly plugged in**
- *Plug unit in firmly*
- **No voltage in wall plug**
- *Check fuse or breaker*
- **Blown fuse/tripped breaker**
- *Replace fuse/reset breaker*

Problem: Cleaner won't pick up

Possible cause
Possible solution

- **Broken or worn belt**
- *Replace belt*
- **Agitator brush roll worn**
- *Replace brush roll*
- **Dirt cup full**
- *Empty dirt cup*
- **Cloth bag dirty**
- *Push sides of bag in and pull out. Empty dirt cup*

